

# THE ATRIUM STATE HOUSE ENTRANCE

2 Morledge Street, Leicester, LE1 1ST

ANDREW  
GRANGER & CO

Part of

SHELDON  
BOSLEY  
KNIGHT

LAND AND  
PROPERTY  
PROFESSIONALS



# Property Description

Located on the top floor of the sought-after Atrium development in Leicester City Centre, this modern one-bedroom apartment offers stylish urban living. The property features an open-plan living area with a fitted kitchen, a double bedroom, and a contemporary shower room. Residents benefit from lift access and a welcoming lobby.

Perfectly positioned in the heart of the city, The Atrium offers unbeatable access to Leicester's vibrant amenities, including shops, restaurants, and cultural attractions. The train station is just a short walk away, making this an ideal location for professionals and commuters alike.







## GROUND FLOOR

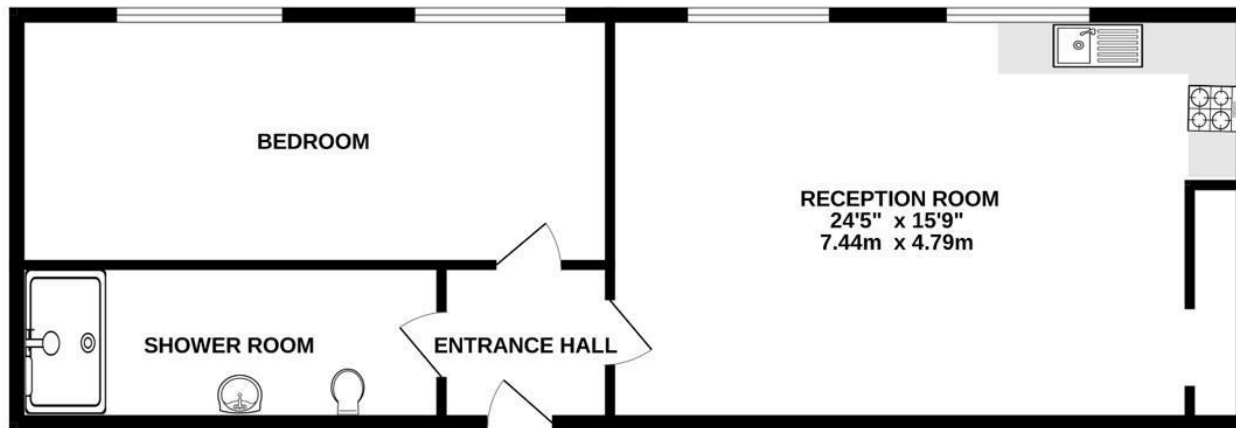

TOTAL FLOOR AREA : 398 sq.ft. (37.0 sq.m.) approx.  
This floor plan is not to scale and is for guidance purposes only  
Made with Metropix ©2025

## Key Features

- No upwards sales chain
- Top floor apartment in prime city centre location
- Located in Leicester's Cultural Quarter
- Internal lobby with elevator access to all floors
- Open plan lounge/kitchen area
- Short walk from a wealth of amenities and Leicester's cultural quarter

**£80,000**

EPC Rating - D

Tenure - Leasehold

Council Tax Band - D

Local Authority -  
Leicester City Council

We routinely refer clients to both our recommended Legal Firm and a panel of Financial Services Providers. It is your decision whether you choose to deal with these companies. In making that decision, you should know that we receive a referral fee